

## Patient Instructions for Use

### Zolpimist (zolpidem tartrate) Oral Spray, Metered for Oral Use

Be sure to carefully read, understand, and follow these instructions so that you use Zolpimist the right way. Ask your doctor or pharmacist if you have any questions about how to use Zolpimist.

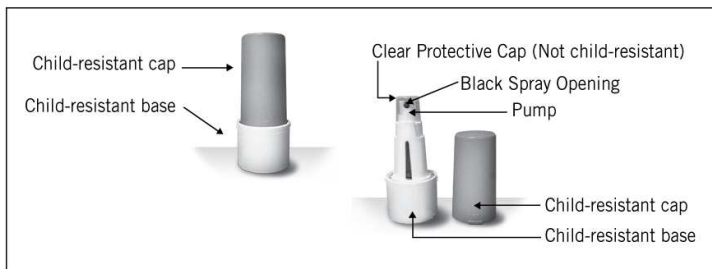

**Priming:** Before you use Zolpimist for the first time or if you have not used Zolpimist for 14 days, you will need to prime the pump (Steps 1-6). Otherwise go directly to Step 7. **To prime the pump:**

1. Line up the arrows on the child-resistant cap and base (see Figure 1).
2. Squeeze the cap at arrows (see Figure 2).
3. Pull the cap and base to separate (see Figure 3).
4. Remove the clear protective cap from the pump (see Figure 4).
5. Hold the container upright. Point the black spray opening in a safe direction away from your face and other people. Fully press down on the pump with your forefinger. Release the pump and let the pump return to the starting position.
6. Follow step 5 and press down on the pump 4 more times. You should see a fine spray. Zolpimist is now ready to use. Now go directly to Step 11.

#### **Taking a dose of Zolpimist:**

• If you are using Zolpimist for the first time or you have not used Zolpimist for 14 days, you will need to prime the pump (Steps 1-6). Otherwise, there is no need to prime the pump.

• Take Zolpimist exactly as prescribed. Do not take more Zolpimist than prescribed for you.

Your doctor will tell you whether to take 1 or 2 sprays of Zolpimist.

- Take Zolpimist right before you get into bed.
- Do not take Zolpimist unless you are able to stay in bed a full night (7-8 hours) before you must be active again.

7. Line up the arrows on the child-resistant cap and base (see Figure 1).
8. Squeeze the cap at arrows (see Figure 2).
9. Pull the cap and base to separate (see Figure 3).
10. Remove the clear protective cap from the pump (see Figure 4).
11. Hold the container upright with the black spray opening pointed directly into your mouth.

Fully press down on the pump to make sure that a full dose of Zolpimist is sprayed directly into your open mouth over your tongue (see Figure 5).

12. Let the pump return to the starting position. If your doctor prescribed only one spray of Zolpimist (5 mg dose), go directly to Step 14.
13. If your doctor prescribes a second spray of Zolpimist (10 mg dose), repeat Step 11.
14. Put the clear protective cap back over the pump at the top of the child-resistant base after each use (see Figure 6).
15. Snap the child-resistant cap back onto the base and rotate the child-resistant cap and the child-resistant base so that the arrows are not lined up (see Figure 7).
16. The child-resistant container should be thrown away when the 60 sprays have been used.

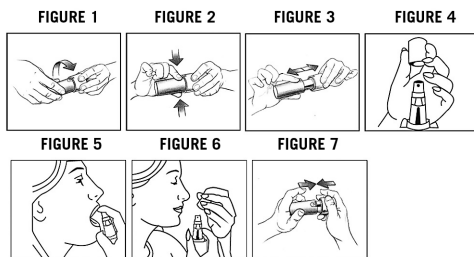

There are no special requirements for cleaning and maintaining Zolpimist. Professional assistance regarding questions about product performance or use can be obtained by calling 1-800-527-1955.

See Medication Guide section "How should I store Zolpimist?" for instructions about how to store Zolpimist.

Manufactured for: ECR Pharmaceuticals;  
Richmond, Virginia 23255  
By: Rechon Life Sciences AB; SE-216 10  
Limhamn, Sweden

Prepared October, 2010  
Copyright, ECR Pharmaceuticals, 2010